



UC Merced HBS-ME Meeting Minutes

Participants: Allison Costa, Nancy Burke, Sidra Goldman-Mellor, Bobbie Henderson, Christine Howe, Asa Bradman(UCM) Matt Pietras, Bryan Irwin, Matthew Gadie (SCB) Martin Gicklhorn (GLP)

Date: February 12, 2021
Project: UCM HBS Bldg DPP
Project Number: 2019053
Copy to: File

From: Matt Pietras
Purpose: Public Health Sub-Ctte Programming Workshop
Location: Web Conference

Attachments: Department/program Diagram

Item	Discussion	Action
1	<p>Ground floor and external/community interacting program</p> <ul style="list-style-type: none"> - Public Health did not have a requirement that its program needed ground floor presence, although it would be preferred for program that has direct research subject interaction – such as the Social Sciences Interview Suite. - During the meeting, sharing of the Social Sciences Interview Suite with Psychology was discussed, and confirmed acceptable. The Social Sciences Interview Suite should be located on the main public entry level. - Social Sciences Research Labs do not have direct public interaction and therefore not required on the ground floor. - Wet Labs and Computational Labs are not to be accessible to the public. - PH is very interested in having their labs grouped together to build a sense of community. The ANR Nutritional Lab will have test subjects come to the lab but PH would prefer to have the Nutritional Lab grouped together with their other labs rather than to have it located on the 1st floor with the Social Sciences Interview Suite. 	

The above constitutes the writer’s understanding of the items discussed and decisions reached. Should any of the participants disagree with this meeting record, contact the writer in writing within five days of the date of this document. Otherwise, the meeting minutes shall stand as the official record of the meeting described above.

ARCHITECTURE	Solomon Cordwell Buenz	www.scb.com
PLANNING	Chicago	T 312.896.1100
INTERIORS	San Francisco	T 415.216.2450



UC Merced HBS-ME Meeting Minutes

2	<p>Individual space breakout meetings</p> <ul style="list-style-type: none"> - Nutrition Lab (59) to understand how it publicly interfaces - Social Science Labs (50) access by test subjects is not anticipated assuming Social Sciences Interview Suite is shared - Social Sciences Interview Suite between Public Health and Psychology - “Dean Suite” (Admin workstations (12), Admin offices (10) and Deans office (8)), to understand the spaces their relationship with each other and the rest of the administrative spaces. - Graduate Workstations (4), to clarify the users and its connection to other spaces relating to graduate students needs. - Large computer lab (29) – formerly labeled as “Large Seminar Room”, to understand its use and flexibility. This is a large room and PH have requested for 2 labs as opposed to 1. 	<p>UCM – Allison to coordinate meetings with appropriate UCM colleagues and SCB</p>
3	<ul style="list-style-type: none"> - Computational Labs (51), to understand the breakup of this space/allocated area. They were formerly labelled as shared spaces but we now understand these are individual to departments. - Wet Labs (58), to understand the privacy needed for this space. SCB have been informed by UCM that this is a secure location and should not be accessed by the public. 	
4	<p>Reception (general topic) - A subject of discussion, from PH's perspective, is how guests are greeted upon arrival. A shared reception for the building or a workstation within HSRI space warrants further discussions.</p>	
5	<p>TA/Hoteling Space (7)</p> <ul style="list-style-type: none"> - This space has been outlined as a shared space in the matrix but is in fact a shared space only between Public Health and Psychology. 	<p>UCM – Maggie or Allison to confirm</p>
6	<p>Waiting Areas</p> <ul style="list-style-type: none"> - Waiting areas are not designated for PH in the matrix, (only in the Social Sciences Interview Suite (and for #57, the PH Reception/Waiting Area) however a zone or area where people can situate themselves would be ideal for students, staff and visitors to avoid users using corridors or other spaces as make shift waiting areas. 	
7	<p>Social Science Interview Suite</p> <ul style="list-style-type: none"> - Per PH, this space is to be shared with Psychology. Who manages this space? Is it a core space, or overseen by one department? 	<p>UCM – Maggie or Allison to confirm</p>

The above constitutes the writer's understanding of the items discussed and decisions reached. Should any of the participants disagree with this meeting record, contact the writer in writing within five days of the date of this document. Otherwise, the meeting minutes shall stand as the official record of the meeting described above.



UC Merced HBS-ME Meeting Minutes

8	Med/Grad Student Facilities <ul style="list-style-type: none">- PH require these facilities, Psychology have also a need for this space and have requested it be dedicated to them, is it ok be shared between departments? This could be discussed in the PH x Psych break out meeting.	
9	See attached program adjacency diagram for further detail.	

End of notes.

The above constitutes the writer's understanding of the items discussed and decisions reached. Should any of the participants disagree with this meeting record, contact the writer in writing within five days of the date of this document. Otherwise, the meeting minutes shall stand as the official record of the meeting described above.

ARCHITECTURE Solomon Cordwell Buenz www.scb.com
PLANNING Chicago T 312.896.1100
INTERIORS San Francisco T 415.216.2450

PUBLIC HEALTH ADJACENCY DIAGRAM

LEGEND

- PRIVATE WORKSPACE/OFFICE
- SEMI PRIVATE WORKSPACE/OFFICE
- SUPPORT SPACE
- TEACHING/LAB SPACE
- CIRCULATION/UTILITY SPACES
- SHARED LABS/SPACES
- ACCESS/ENTRANCE
- POSSIBLE CONNECTION
- CLEAR CONNECTION
- 21 -** NUMBERS SIGNIFY SPACE TYPE NUMBER. REF TO EXCEL DOCUMENT.

COMMUNITY / EXTERNAL

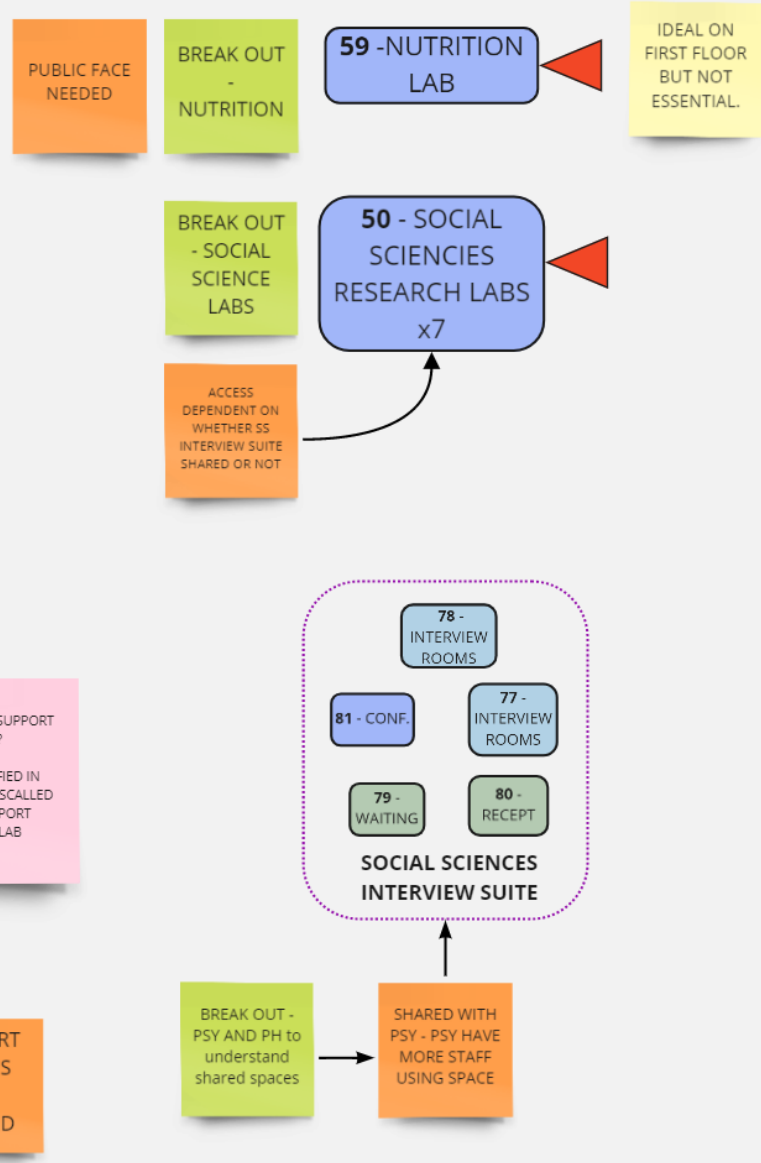

CORE FACILITY / SHARED SPACE

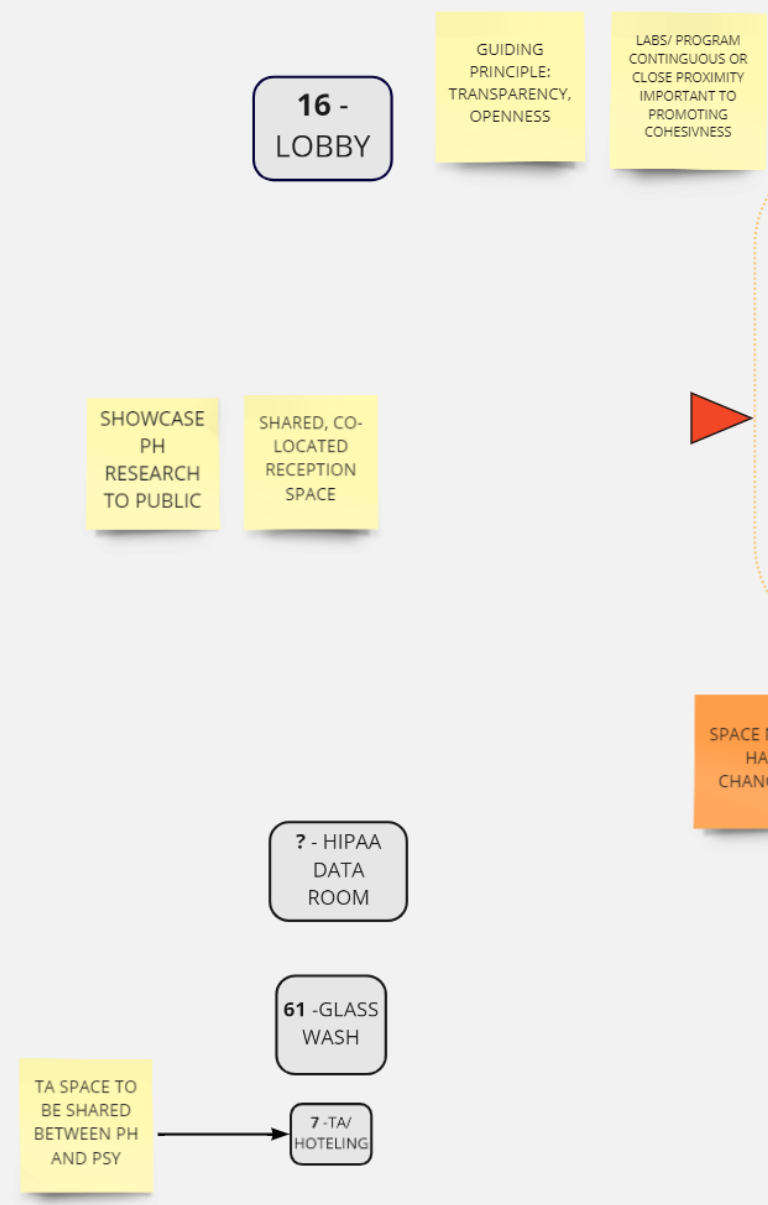

CAMPUS / INTERNAL



UNASSIGNED

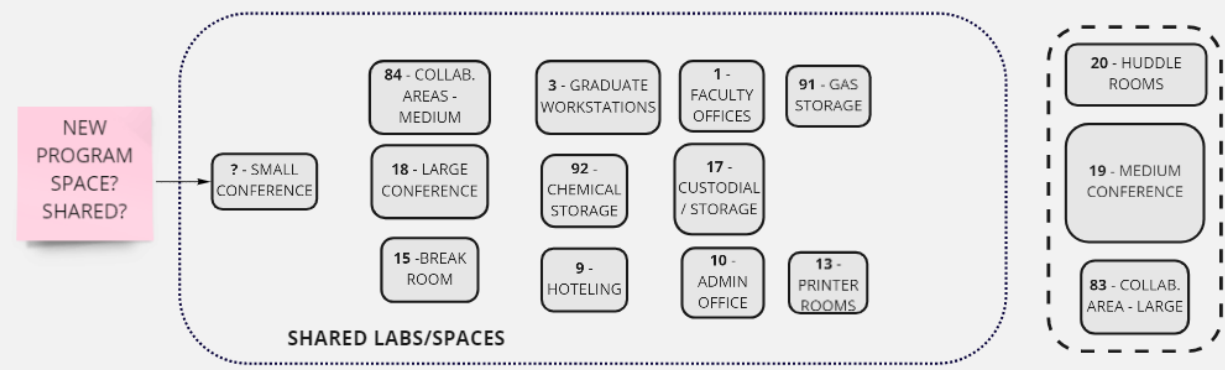

- SCB QUESTIONS
- ACTIONS TO BE TAKEN BY INDIVIDUALS
- COMMENTS ON SPACES AND DEPARTMENT NEEDS
- GENERAL NOTES