

Present at 3 May 2021 Program Breakout Mtg. #1:

UCM: Bobbi Henderson, Deb Wiebe, Rudy Ortiz, Matthew Zawadzki

SCB/GLP Team: Matt Pietras-SCB, Martin Gicklhorn-GLP

Notes of 3 May Breakout Mtg. #1:

Program Space Allocation:

Two Sample Extraction Labs @160 ASF each = 320 ASF (This was revised to two Sample Extraction Labs @120 ASF each + one Lab Support Room @ 8 ASF = 320 ASF)

1. **Discuss Space Options:**

- A. **Option 1:** Two Sample Extraction Labs @ 160 ASF each. ***This Option was not selected at the 5/3 Mtg.***
- B. **Option 2:** Two Sample Extraction Labs @ 120 ASF each with a small, shared waiting area @80 ASF ***This Option was not selected at the 5/3 Mtg., but a waiting area was thought to be needed. There was strong consensus for co-locating the Sample Extraction Labs with the Social Sciences Interview Suite so the Sample Extraction Labs could make use of the Social Sciences Int. Suite Waiting Area.***
- C. **Option 3:** Two Sample Extraction Labs @ 120 ASF each with a small, shared gender-neutral Restroom @ 80 ASF ***This Option was not selected at the 5/3 Mtg., but a private Restroom was thought to be needed or these labs should be located in close proximity to a restroom to limit the sample carrying in the building corridors. There was strong consensus for co-locating the Sample Extraction Labs with the Social Sciences Interview Suite so the Sample Extraction Labs could make use of the Social Sciences Int. Suite Restroom.***
- D. **Option 4:** ***Two Sample Extraction Labs @ 120 ASF each with a shared lab support space for shared equipment and lockable storage of PI owned equipment @ 80 ASF was the selected option. There was strong consensus for co-locating the Sample Extraction Labs with the Social Sciences Interview Suite so the Sample Extraction Labs could make use of the Social Sciences Int. Suite Restroom and Waiting Area.***

2. **Preliminary Information Gathering including Vital Statistics and Consenting:**

- A. Height
- B. Weight
- C. Blood Pressure
- D. ***Ultrasonic (portable on mobile cart)***
- E. ***Non-invasive Stress Recorders***
- F. ***Telemetry***
- G. ***Some consenting steps may also take place in these rooms.***

3. **Range of samples to be collected:**

- A. Saliva

- B. Blood *(They contract out their phlebotomy and phlebotomists come to the building for this. At times, for past studies, they have had three phlebotomists working 6-8 phlebotomy stations at a time. The Phlebotomists can bring their own equipment but having the phlebotomy chairs in the rooms was thought to be the best approach.*
 - C. Urine
 - D. Breast milk
 - E. **Hair**
 - F. **Fecal Matter (Poop)**
4. Equipment in Rooms: *(Some equip will be owned by specific PIs and some will be shared)*
- A. Sink/countertop (with Hot/Cold Water – no purified water)
 - B. Scale / Height Measure
 - C. **No shared computers are to be in the room. Researchers will bring their own computers.**
 - D. Chairs
 - 1. Standard Chair *(one per lab)*
 - 2. Blood Draw Chair *(three per lab)*
 - E. Refrigerator (undercounter model)
 - F. Lockable Storage cabinets *in Lab Support Room. Each PI that makes use of these spaces have a lockable cabinet.*
 - G. No services such as compressed air or lab vacuum *(confirmed).*
 - H. PPE dispenser *(gloves only no safety glasses)*
 - I. Lab Coat Hooks/Rack: **Researchers will bring their own lab coats from their labs so there will not be a need for lab coat storage (hooks or rack) in these labs.**
 - J. **A Cosmed Bod Pod (body composition assessment device) may be added in the future**
 - K. **Biohazard waste container in each lab**
 - L. **Some instruments on rolling cart such as the Ultrasonic Equipment.**

End of Notes

This Option was eliminated at the 5/3 Breakout Mtg.

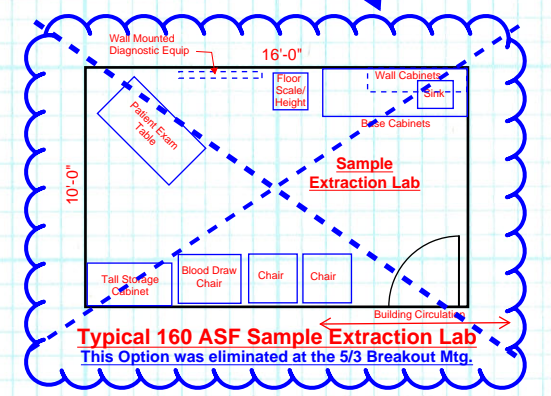

Typical 160 ASF Sample Extraction Lab
This Option was eliminated at the 5/3 Breakout Mtg.

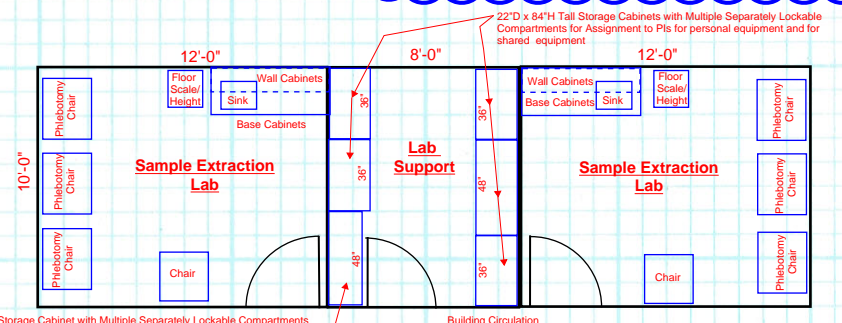

16'D x 84'H Tall Storage Cabinet with Multiple Separately Lockable Compartments for Assignment to PIs and for storage of shared lab equipment / lab supplies.
22'D x 84'H Tall Storage Cabinets with Multiple Separately Lockable Compartments for Assignment to PIs for personal equipment and for shared equipment.

Two Sample Extraction Labs @ 120 ASF + One Lab Support Space @ 80 ASF
(This is the design direction that was agreed upon at the 5/3 Programming Breakout Mtg.)